

Araldite®

professional adhesives



Araldite® Rapid 24ml Syringe

A strong, long lasting solvent-free adhesive which is water resistant and can be painted or sanded.

Important

Bonds metal, wood, masonry, ceramics, glass, dry concrete, chipboard, leather, cardboard, fabric, rubber and most plastics (except polyethylene, polypropylene, Teflon®).

Make sure surfaces are clean and free from dust, corrosion, dirt and grease.

For optimum bonding, slightly roughen surfaces with sandpaper and degrease metals with a suitable solvent.

During assembly apply light pressure to the joint until set (clamps, tape) around 20 minutes.

Allow 3 hours to attain full strength before rough handling or sanding.

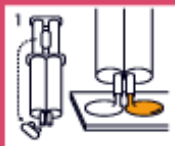

1 Snap off the resealable cap from between the syringe plungers and break off the end seal. Depress the plunger to dispense equal amounts of both components onto a clean disposable surface. Re-fit the cap to close the nozzle.

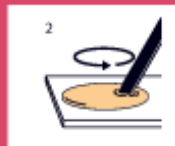

2 Mix thoroughly for at least 30 seconds until well mixed. Araldite® Rapid remains usable for max. 5 minutes.



3 Make sure both surfaces are clean and dry. Apply to both surfaces of the joint.

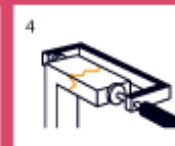

4 Assemble carefully and remove any excess adhesive with a sharp blade once partially set.

How to apply

Araldite® Rapid is a strong 2-component epoxy with fast setting. Parts repositionable for 4 minutes. High temperature resistance (-30°C to 65°C). Oil, chemical and impact resistant.

Do not use to repair or bond items that will contact food or drink. Not recommended for bonding rear-view mirrors to car windscreens.

Storage

Should be stored in a dry place at room temperature in the original syringe.

New

Environmentally friendly product formulation plus eco-friendly packaging for easy recycling

Copyright® 2011 . Huntsman Advanced Materials (Switzerland) GmbH. All Rights Reserved.

Araldite® is a registered trademark of Huntsman Corporation or an affiliate thereof in one or more, but not all countries.

www.go-araldite.com